



# USER'S GUIDE TELEVISION



**FIBRE**  
ARGENTEUIL



# Synchronization

## Synchronizing the remote control with the decoder

1. Use your TV remote control to select the decoder's HDMI port in the "Sources" menu.
2. Point the new remote control at the set-top box.
3. Hold down the OK and APPS buttons simultaneously for 5 seconds. Release both keys. A screen will appear. Again, hold down the OK and APPS keys simultaneously for 5 seconds. Release both keys and a message will appear at the bottom of the screen indicating successful pairing.
4. Follow the instructions on the new screen. Click on start, and the device will detect the TV model. The TV's volume control and power buttons will synchronize.

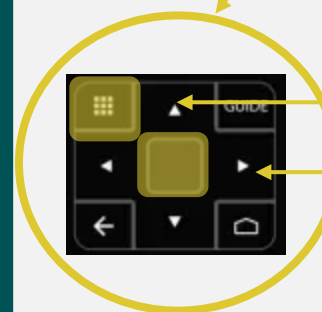
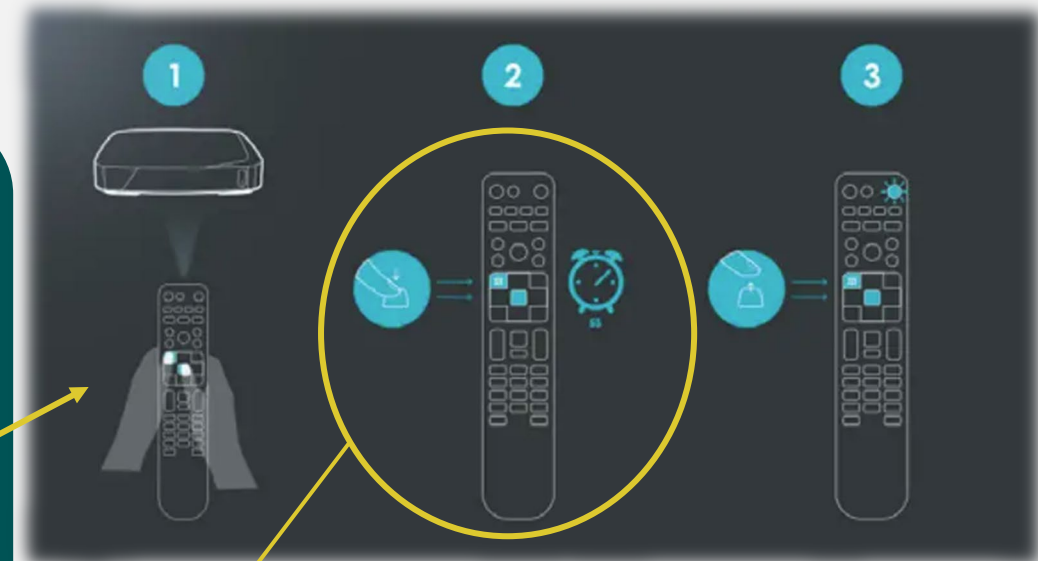

Application button (**APPS**)

**OK** button

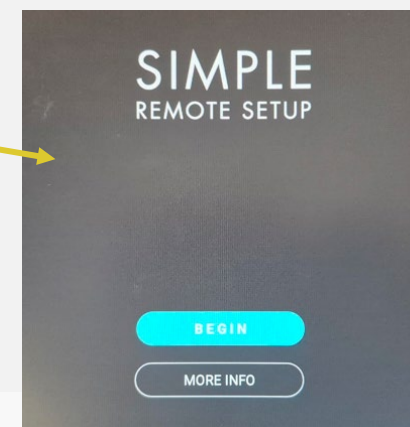





# REMOTE CONTROL

---

# REMOTE CONTROL



## \*Menus A, B and voice control

- **A button:** Opens the navigation menu at the bottom of your screen.
- **B button:** This takes you directly to the recording's menu.
- **Voice Command:** Activates the Google Assistant to access the decoder's applications. It can only be used outside the Fibre Argenteuil environment. For more information, please visit [assistant.google.com](https://assistant.google.com).

## Remote control functions for decoder control

1. Select TV input source.
2. Switch the TV on and off.
3. Shortcut for certain menus\*.
4. Control recording and delay mode.
5. Access application menu.
6. Navigate menu and confirm.
7. Exit menus.
8. Adjust TV volume.
9. Select a channel or enter text.
10. Get detailed description of TV content.
11. Search for content.
12. Microphone.
13. Switch decoder on and off.
14. Access channel guide.
15. Access Android TV main menu.
16. Activate voice command\*.
17. Navigate channels.
18. Mute volume.
19. Activate / deactivate subtitles.
20. Return to previous channel.
21. View battery status

# The remote control and its main buttons

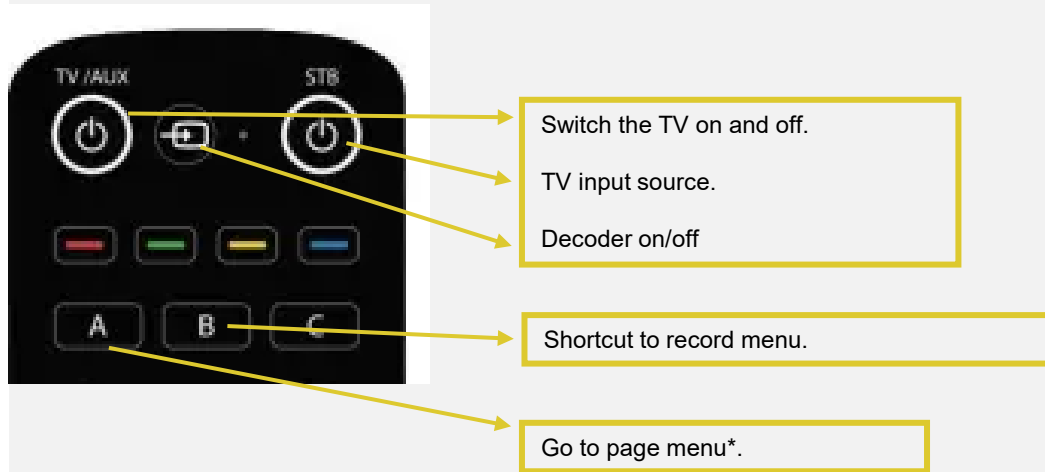

\*When you're listening live and press the "A" button, a menu appears at the bottom of your TV:



\*When you are in the channel guide and press the "A" button, a different menu opens at the bottom of your TV:



\*When you are in a recording or replay mode, pressing the "A" key displays a menu with the progress bar of your content. This allows you to view your current position in the playback and navigate more quickly.

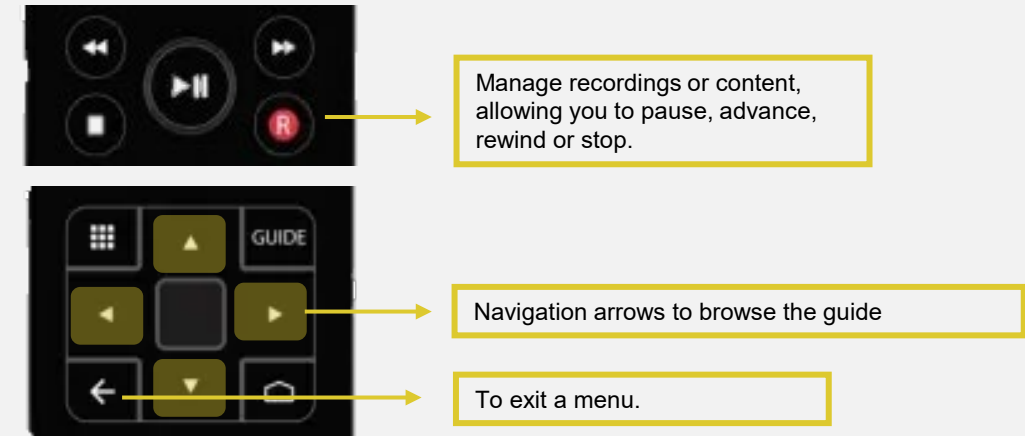
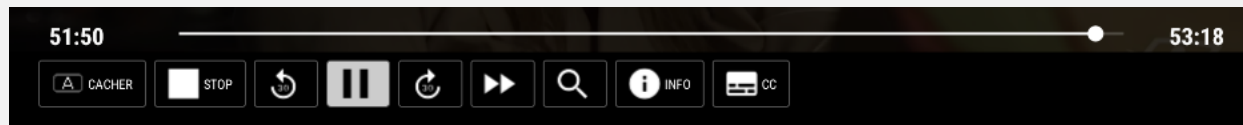



# NAVIGATION GUIDE

---

# Navigation guide options

Did you know that your guide includes color codes for each program category?

**SERIES** – **SPORT** – **MOVIE** – **KIDS**

When you are in the navigation guide menu, press the A button on your remote control. A menu will appear at the bottom of your TV screen.





## The “DATE” menu options

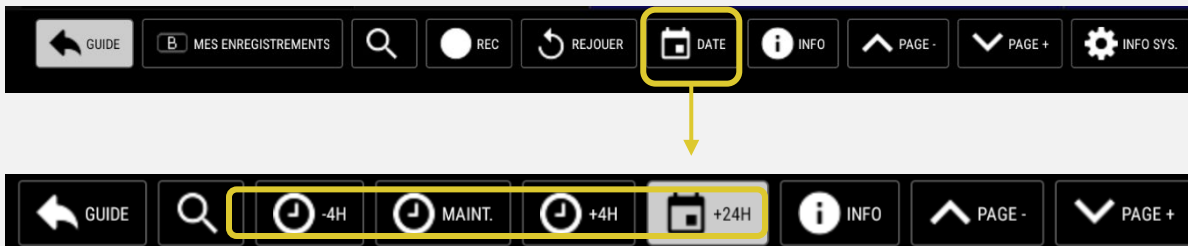

This selection gives you access to a menu that allows you to move through the guide in blocks of : **- 4h, +4h, +24h**. You can return to the current time by selecting



## Menu functions

- View your recordings by selecting
- Perform a search by selecting
- Save or restart content  
- Find out about content by selecting 
- Select the arrows and make page skips of 5 channels at a time in the guide.  





**LIVE**





---

**TELEVISION**







# Live TV and the “Replay” option

## Live TV

- Press the button  on your remote control. The channel guide will appear on your TV screen.
- Press one of the buttons  on your remote control to navigate the channel guide. Your selection will be highlighted on your TV screen.
- To find out about the content, press the button  on your remote control, and the description will appear on the screen.
- Press the  on your remote control to confirm your live listening selection.

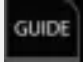
## Replay option \*

Missed a program? This option lets you go back up to 24 hours in the channel guide.

- Press the button  on your remote control. The channel guide will appear on your TV screen.
- Press one of the buttons  on your remote control to navigate the channel guide. Select content that has already been broadcast and press the .
- A window will open displaying the content information, accompanied by a menu at the bottom of the page.
- Select the PLAY option from the menu and confirm by pressing . Content will begin.

\*Applicable only if you have the Multi-TV Recorder option.



# RECORDINGS

---

# Recordings

## Helpful hints

- You can choose a bank of 50 or 120 hours to record your favorite content, giving you access to “Replay”, pause and rewind functions on all the decoders in your home. This option is subject to a charge.
- Only channels marked with this logo  in the channel guide can be recorded.
- You can record 8 programs simultaneously and watch the content of your choice, even if several recordings are in progress.
- If a decoder is broken or replaced, recordings and programming will not be lost. Everything is associated with the account, which is cloud-based.
- Check that you have recording times available to avoid any unpleasant surprises when you next schedule. You'll find this information at the bottom of the recording list.

Espace Disponible 120



Liste des enregistrements (0)		
Le tricheur	Sep 8th	30 min
Question de jugement	Sep 8th	30 min
Ricardo	Sep 8th	30 min
Mario Dumont	Sep 8th	59 min
Ça c'est drôle!	Sep 8th	31 min
TVA nouvelles	Sep 8th	35 min

Espace Disponible: 150h

## For recording

1. To access the channel menu, press the “GUIDE” button on your remote control.
2. Use the arrow keys on your remote control to navigate through the guide. Select the desired content, which will be highlighted on your TV screen.
3. Then press the “RECORD” button on your remote control. An information window and menu will appear.
4. To proceed, move the highlight to the RECORD option using the arrows on the remote control, then press the central “OK” button. A new window will confirm that your registration has been accepted.
5. To return to the channel guide, press the “RETURN” arrow on your remote control.

When you start watching a TV program that's already on air, you have the option of rewinding it from the beginning or recording it.



# Series and repeat recording

## Series recording

1. Repeat the previous steps.
2. Once you've made your selection, press the "RECORD" button on your remote control. An information message and menu will appear.
3. Use the arrows on your remote control to navigate to "RECORD SERIES" and press "OK". A new window will inform you that all new episodes will be recorded automatically.
4. Press "OK" to confirm.
5. Then press "RETURN" to return to the channel menu

### Series recording menu



### Confirmation of your choice of serial recording

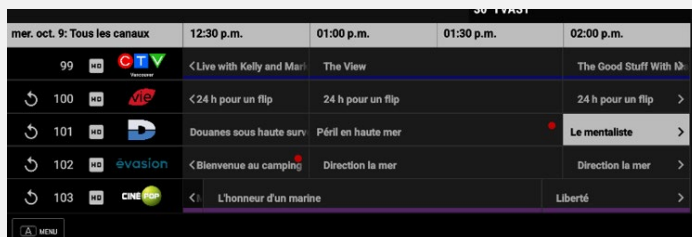

## Recording on repeat

1. Repeat the previous steps
2. Once you've made your selection, press the "RECORD" button on your remote control. An information window and menu will appear.
3. Use the arrows on your remote control to navigate to "RECORD", then press "OK". A new window will open, asking you what type of recording you'd like. Select your choice using the arrows.
4. To confirm your selection, press the "OK" button on your remote control.
5. Finally, press the "RETURN" button to return to the channel menu.

### Menu to select your recording choice



\*This recording option will only be available if series recording is not available in the content information..

## Recording menu

1. Press the B key or blue button to go directly to your recording's menu.

The number in the gray square indicates the number of episodes recorded for this series. 

The eye icon indicates that this content has been viewed or started. 

If there is nothing, this means that the content has not yet been viewed.

2. Use the arrows to select the desired content, then press "OK". At the bottom of the list, you'll find the number of hours remaining for your recordings.



# Delete recordings

## To delete my recordings

If you are in a recording and wish to delete it, it is essential to press the “Stop” button and then follow the instructions.

1. Press the B or green button to go directly to your recording's menu
2. Use the arrows to select the desired content, then press “OK”. At the bottom of the list, you'll have the following options: Delete all viewed episodes, Delete all episodes or Cancel series.
3. Make your choice.
4. When you select an episode, the content information will present you with three options: Play, Delete or Cancel series.
5. Make your choice.

## Recording list



## Information on content

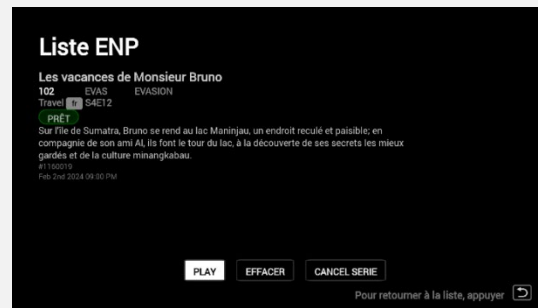

## Confirmation of your action

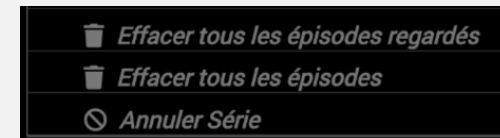
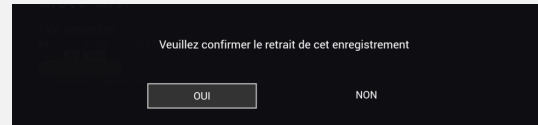

**Cancel series:** You stop all future programming but keep those already saved.

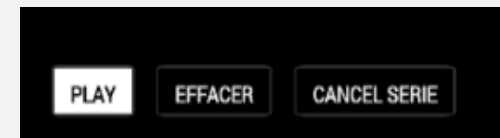

## Play content

## Delete content

**Cancel series:** You stop all future programming but keep those already recorded.

Each time you make a selection to delete, you will be asked to confirm.

# Quick technical support

## Frequently encountered situations

- How do I get back to the Fibre Argenteuil guide? If you're using the applications on the Amino decoder, go to the “Application” tab at the top of the screen, then select the FibreArgenteuiltvguide logo to be redirected to the Argenteuil Fibre guide.
- In the event of a return following a power outage, the decoder generally restarts faster than the router. This may result in an error message indicating that there is no Internet connection or that the decoder remains in standby mode. In this case, disconnect the power supply at the back of the decoder, then reconnect it.
- To solve sound problems, remember that every TV behaves differently. You can try connecting the HDMI cable to another port on your TV. Don't forget to change the source to match the port you've chosen.
- Regarding picture quality, if you've changed TV provider and are connecting a new set-top box to your TV, you may need to adjust the picture settings. Please refer to your TV set's instructions.
- The “OK” button, located in the center of the directional arrows, can sometimes be tricky to use. If you press this button for too long, a menu will open at the bottom of your TV instead of performing its main function, which is to confirm.

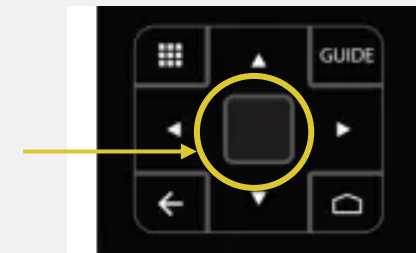
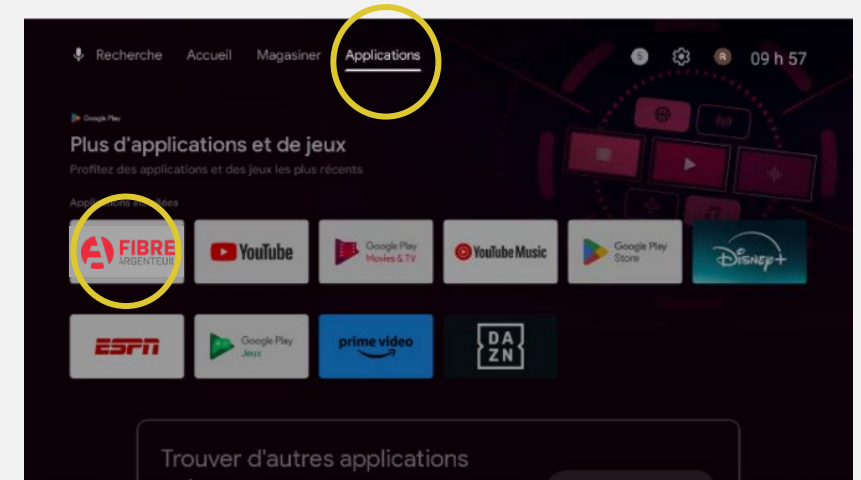



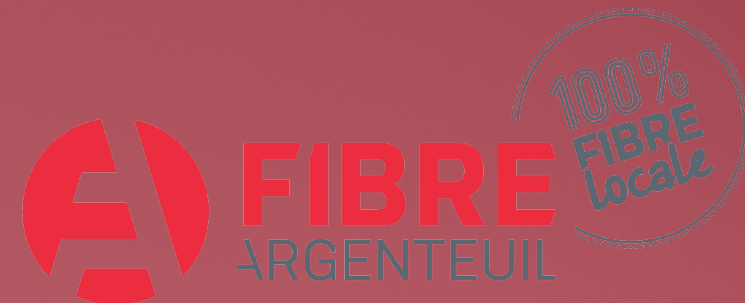

# THANK YOU FOR CHOOSING US

---

If you have any questions, please don't  
hesitate to contact us at 450-409-2012.